

EMS Annual Meeting 2019 – floor plan Overview

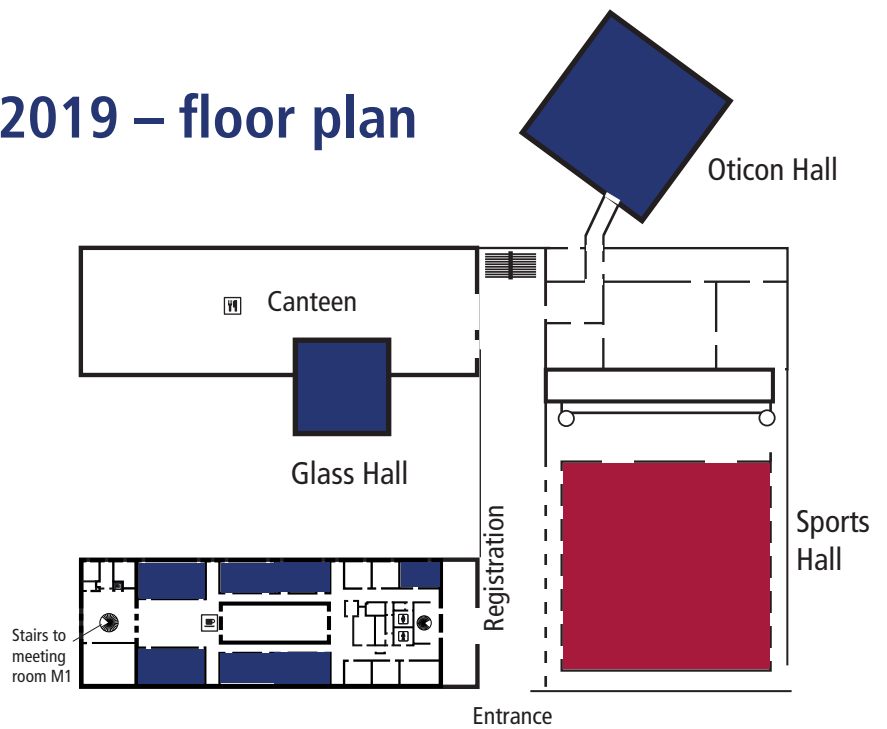

Lecture rooms: Oticon Hall, Glass Hall, M1, S1, S4, S9
 Side meeting rooms: S8, S12

Working room: S10
 Special Events room: S2

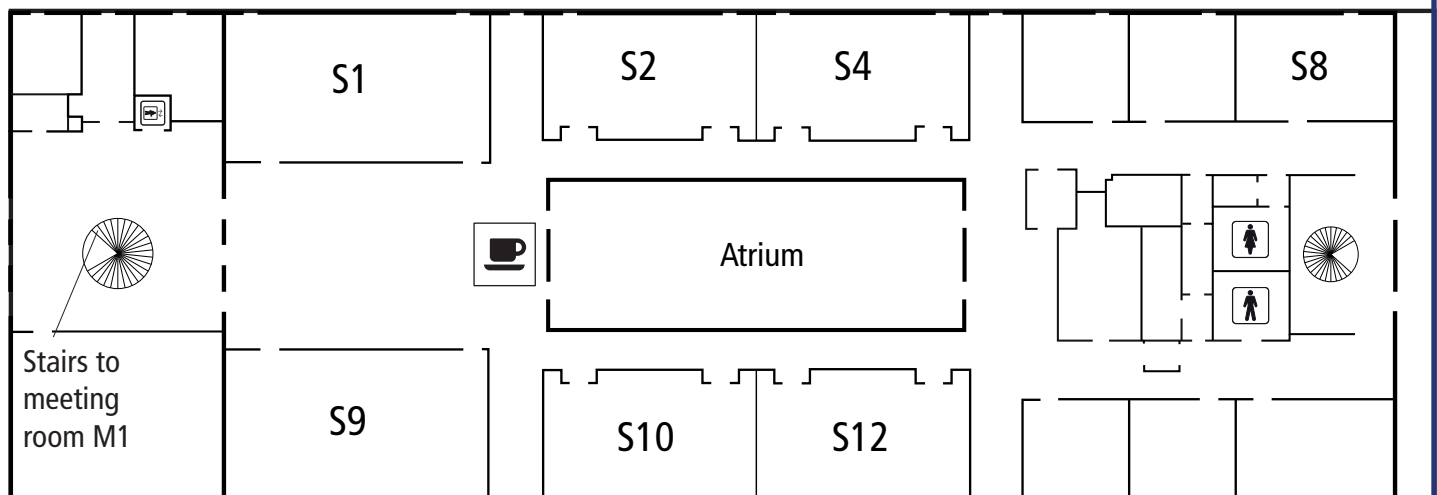

Sports Hall

Posters, exhibition, seating area, and coffee breaks:

List of exhibitors:

- #1 Atmosphere-MDPI
- #2 Scintec
- #3 IAP Journals
- #4 PRIMET
- #5 EMS & EMS Members
- #6 Copernicus ECMWF

